

VB1 (19/40)

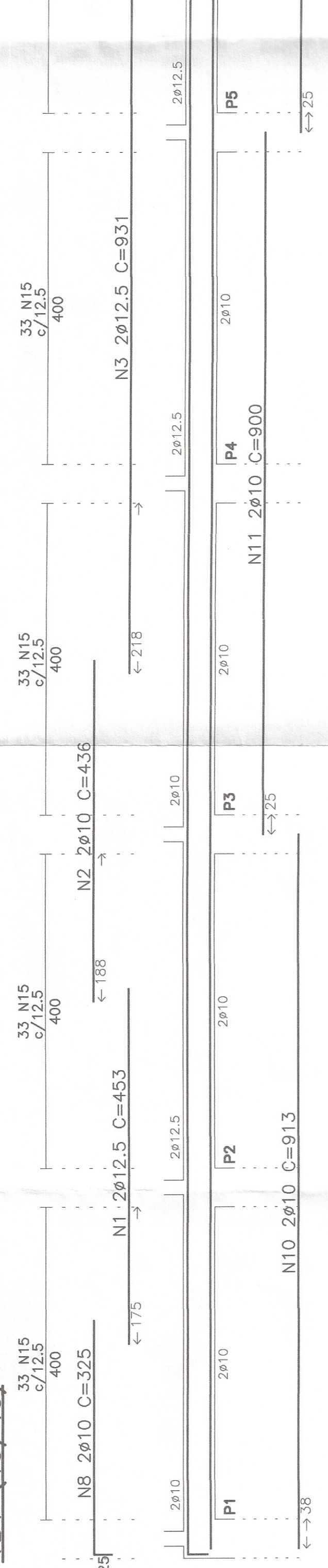

VB2 (19/40)

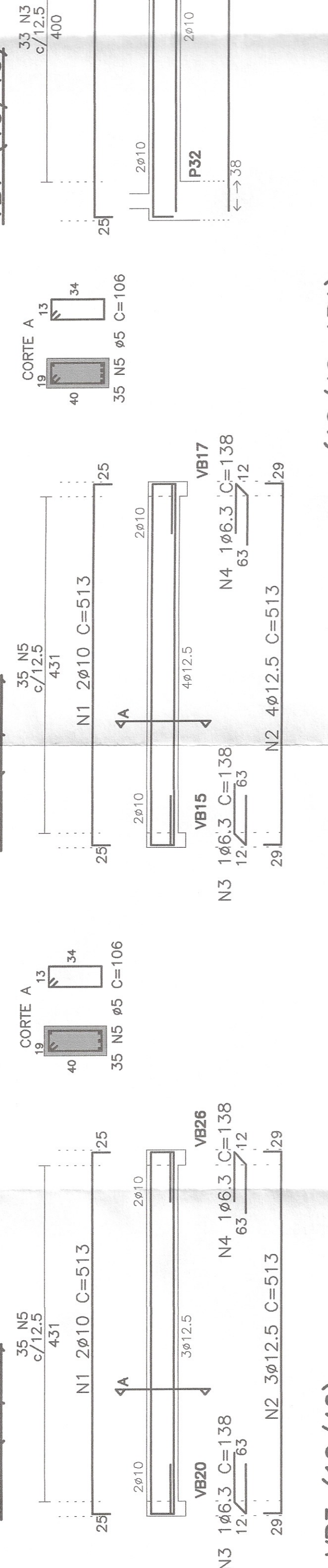

VB3 (19/40)

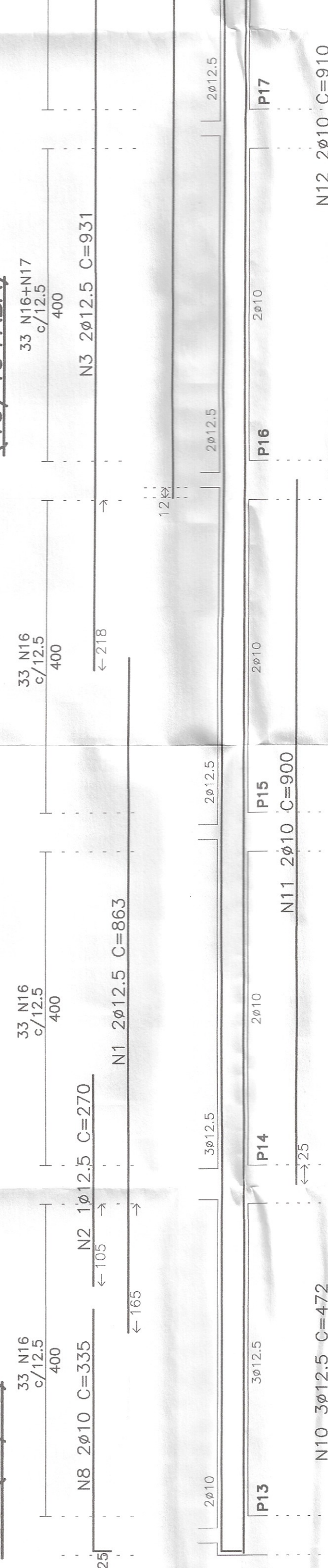

VB5 (19/40)

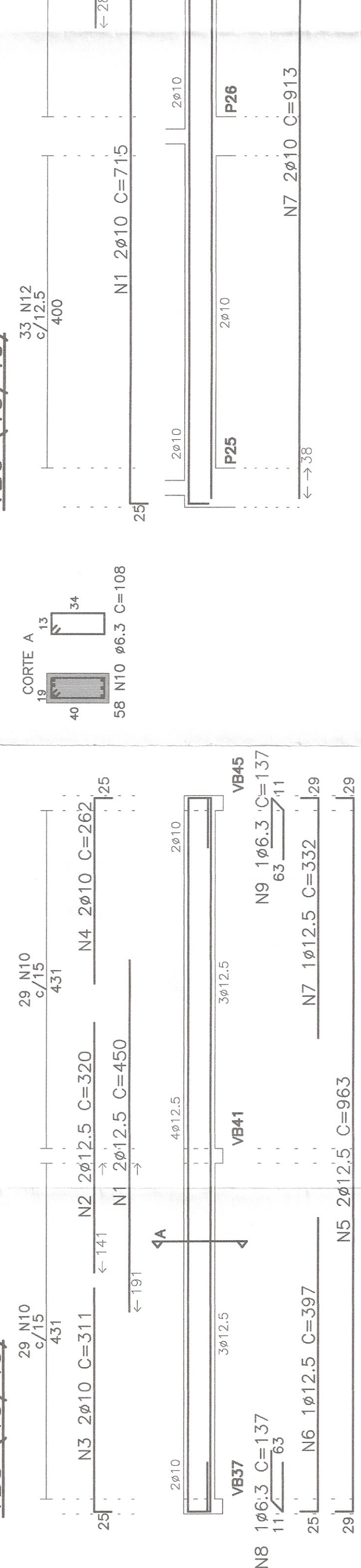

VB11 (19/40)

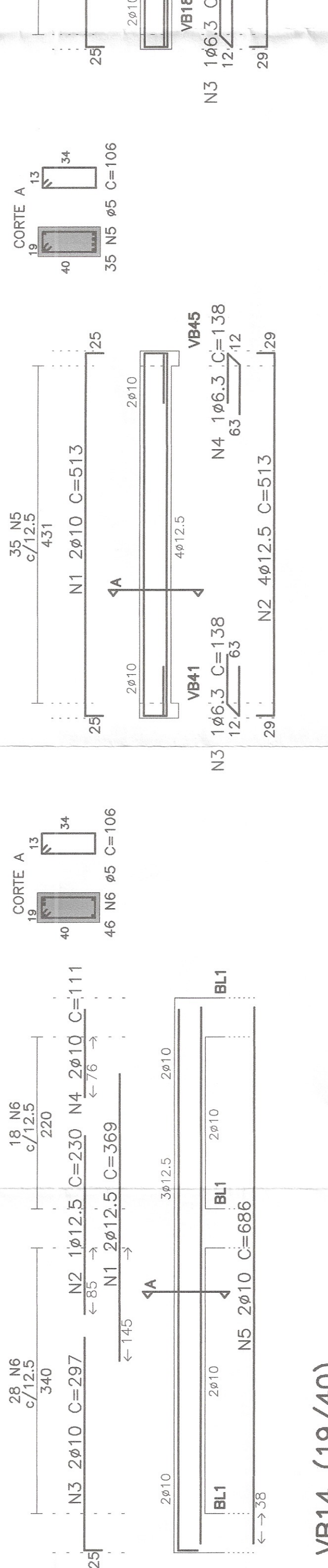

VB14 (19/40)

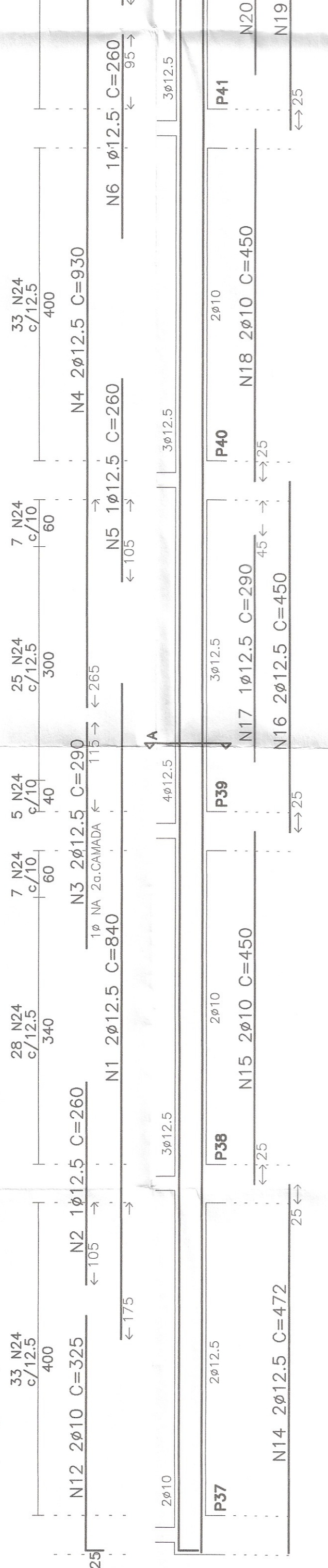

VB15 (19/50)

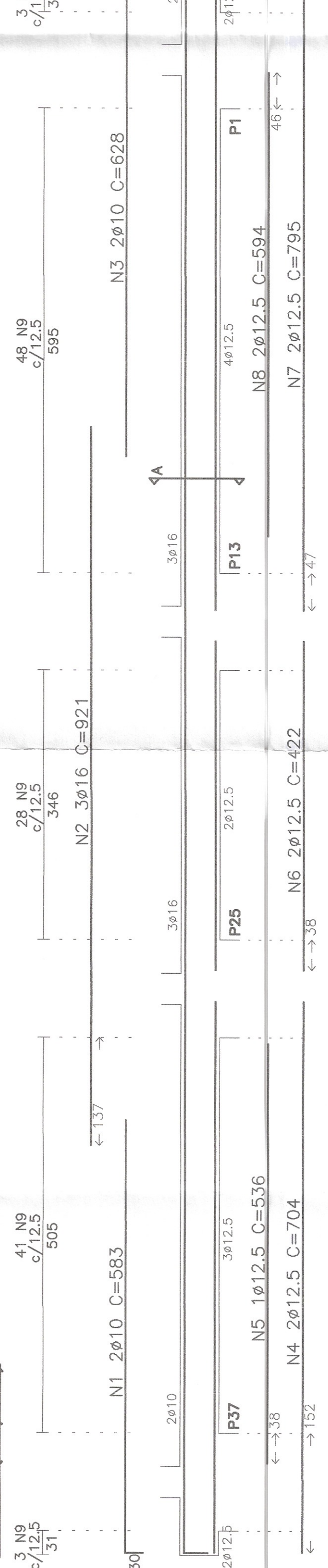

VB4 (19/40)

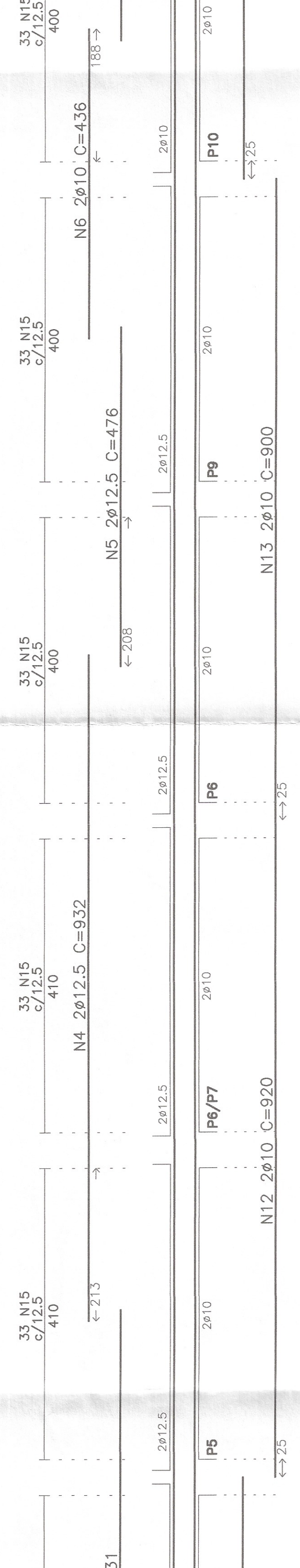

VB7 (19/40)

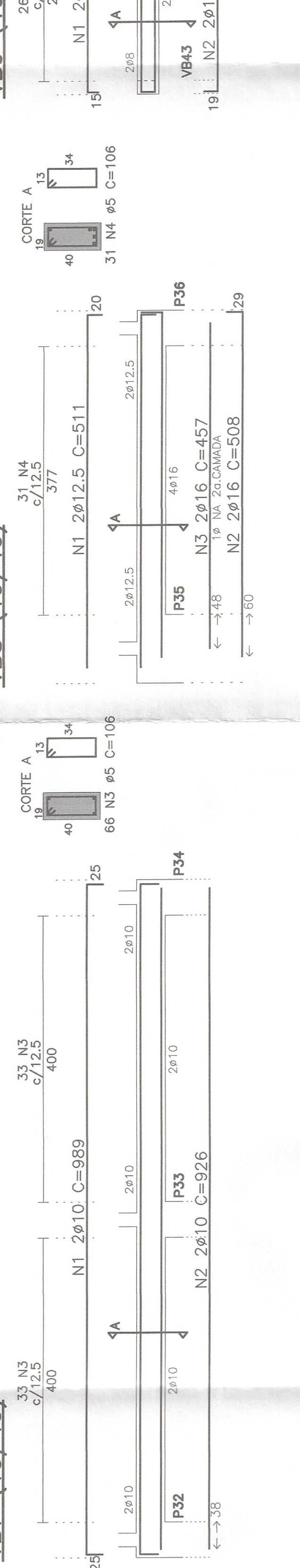

VB8 (19/40)

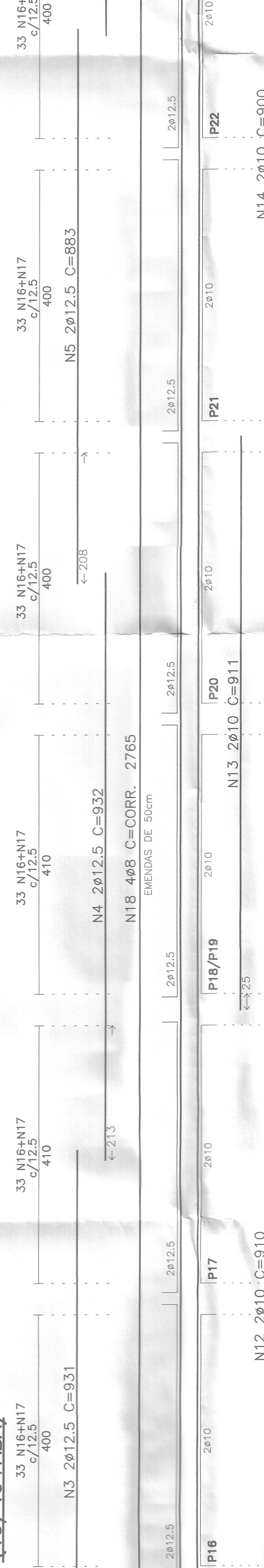

VB6 (19/40)

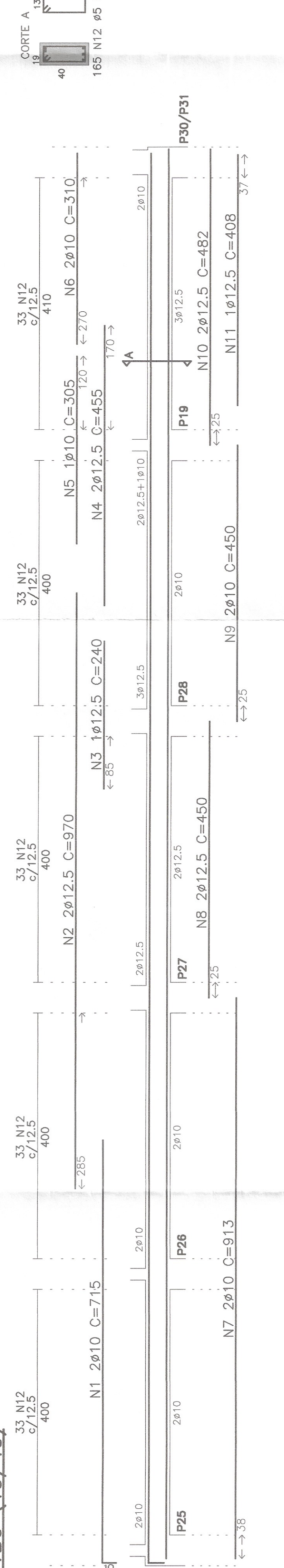

VB12 (19/40)

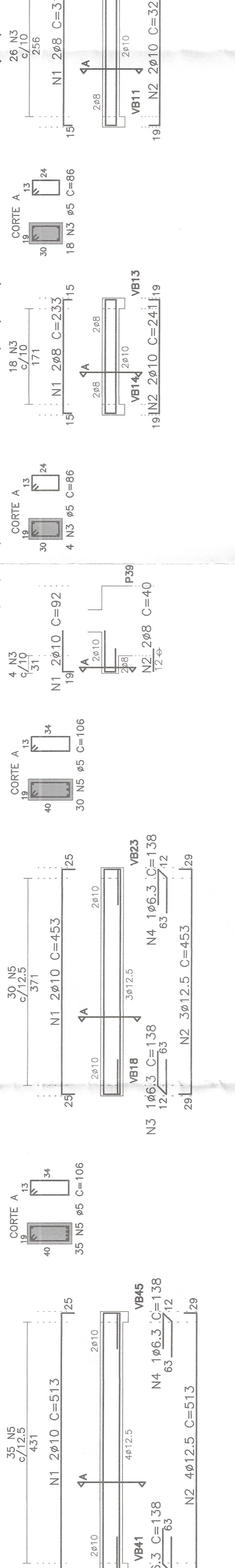

VB13 (19/40)

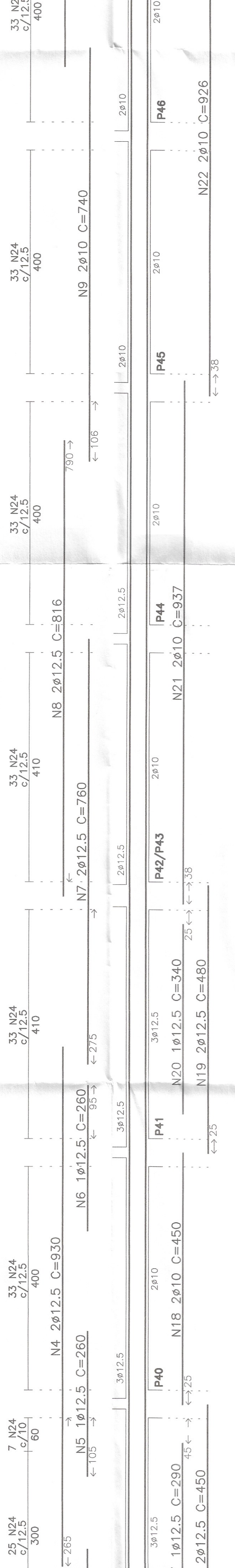

VB17 (19/50)

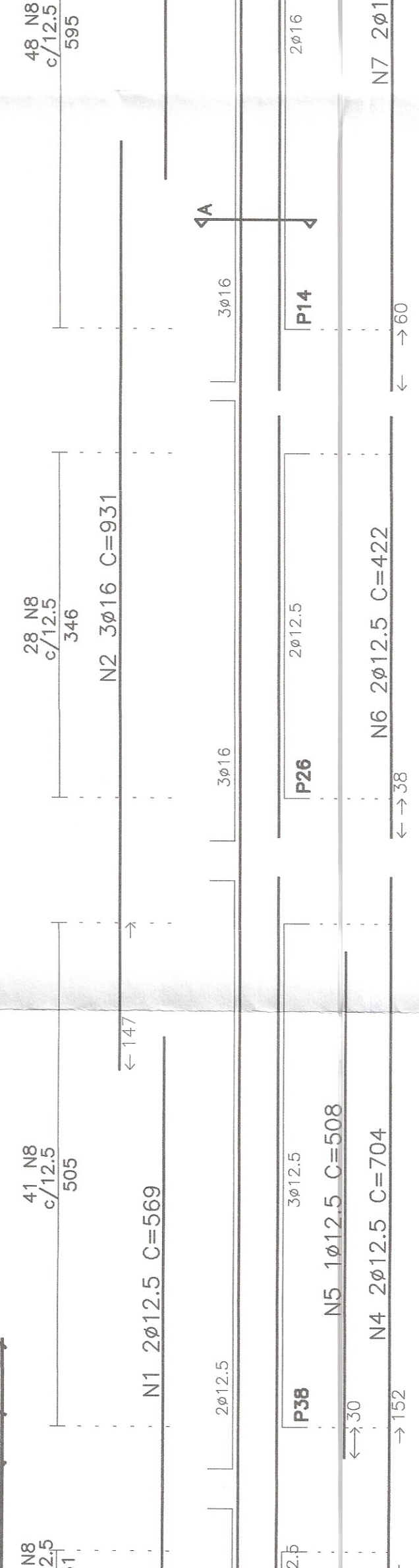

VB17

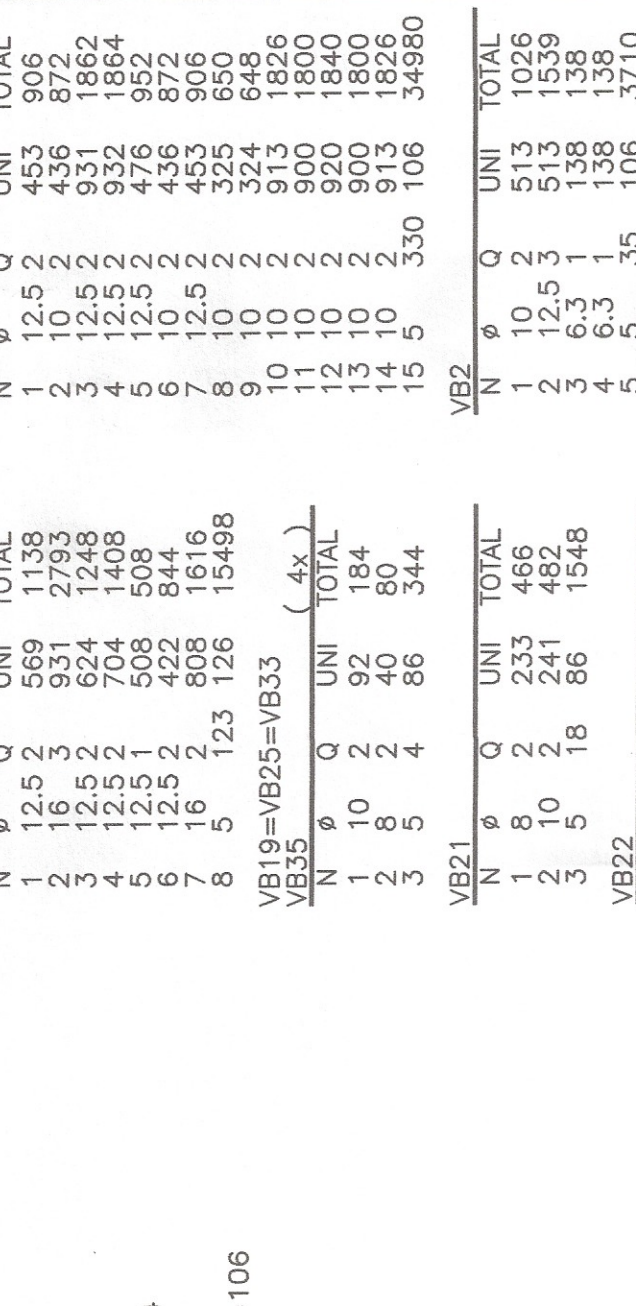

VB16 (19/30)

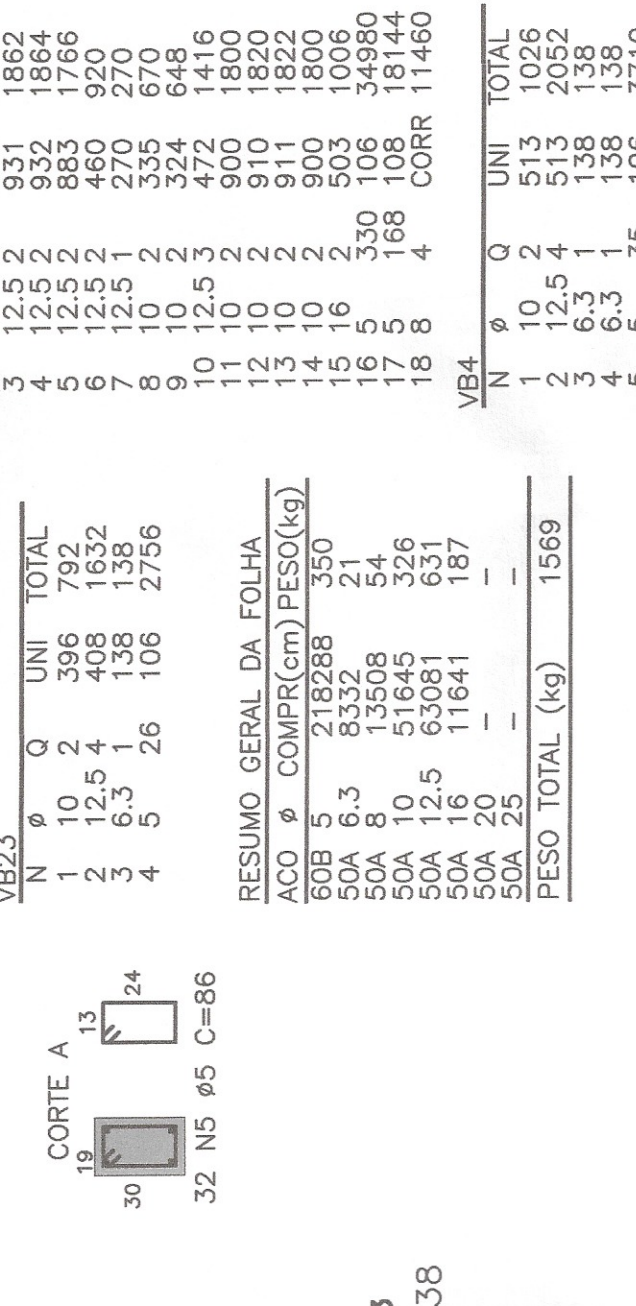

VB9 (19/30)

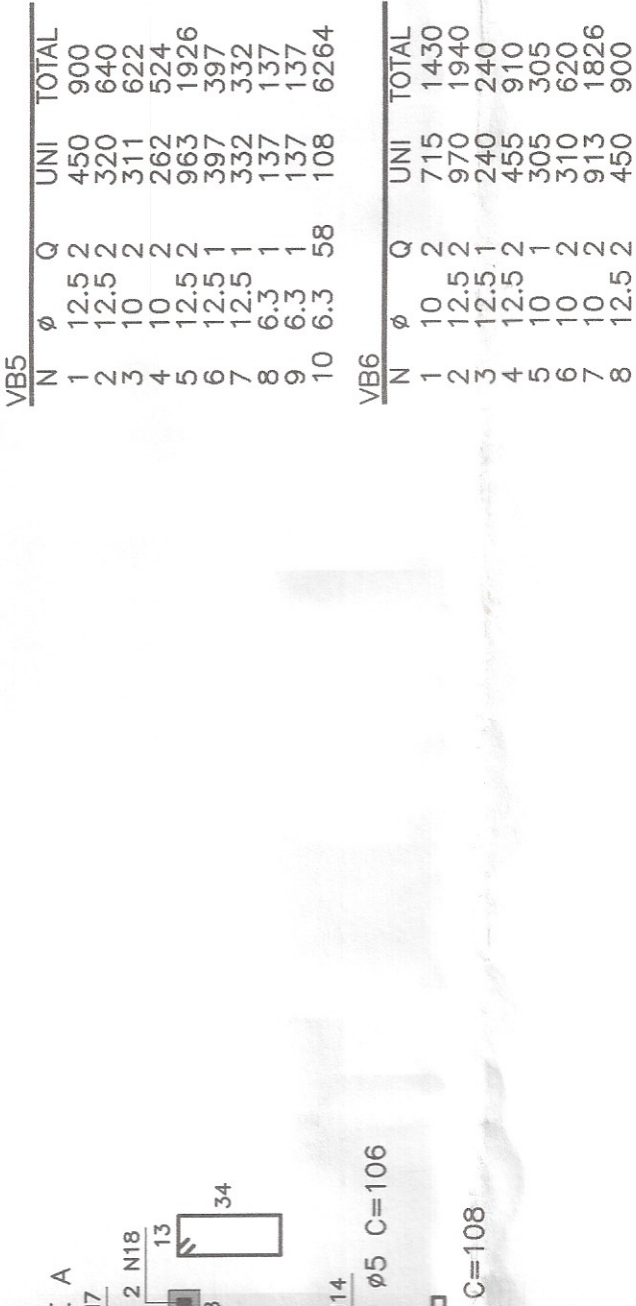

VB10 (19/40)

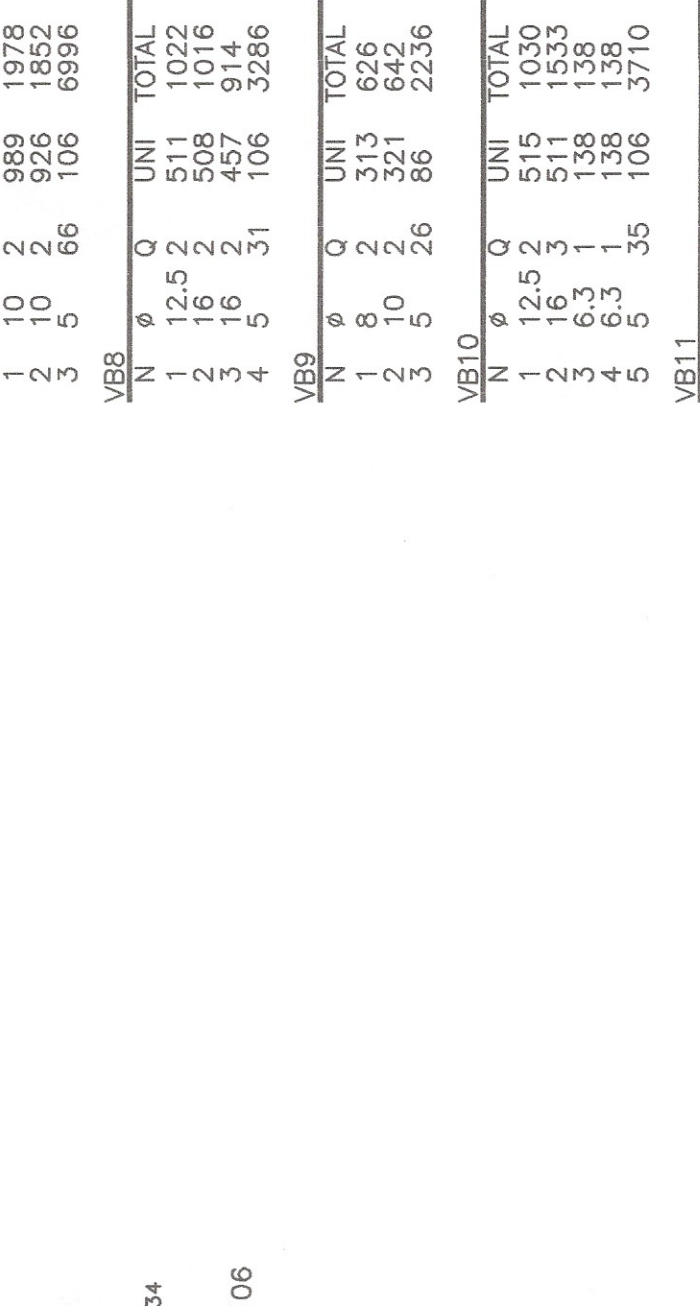

VB22 (19/30)

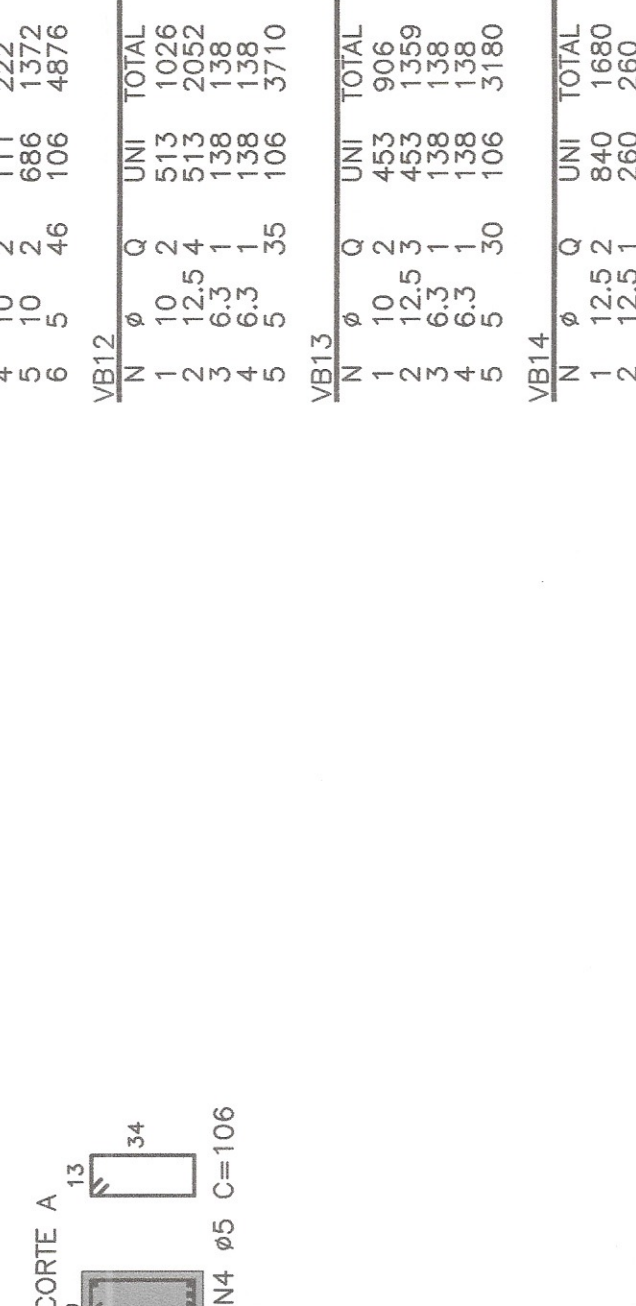

VB23 (19/40)



VB19=VB25=VB33=

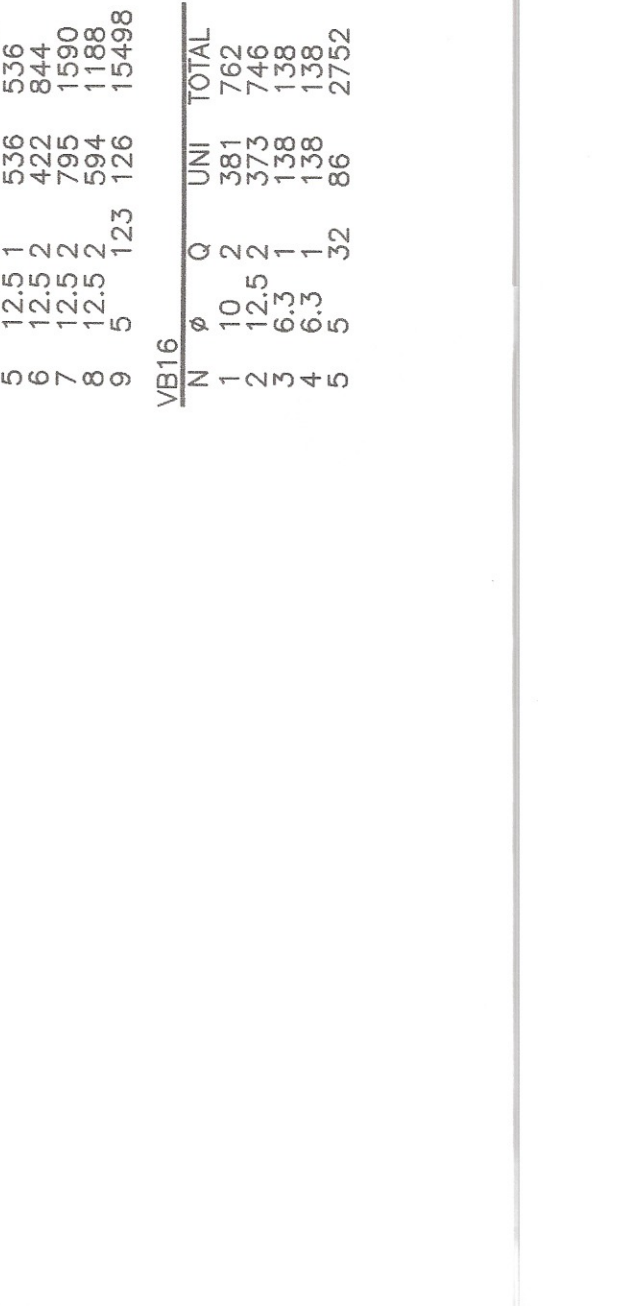

VB1

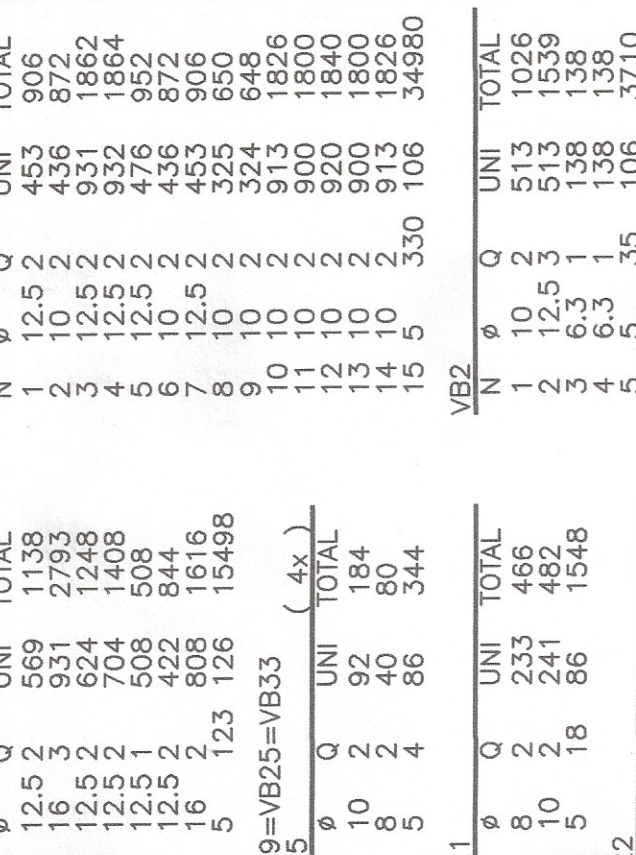

VB2

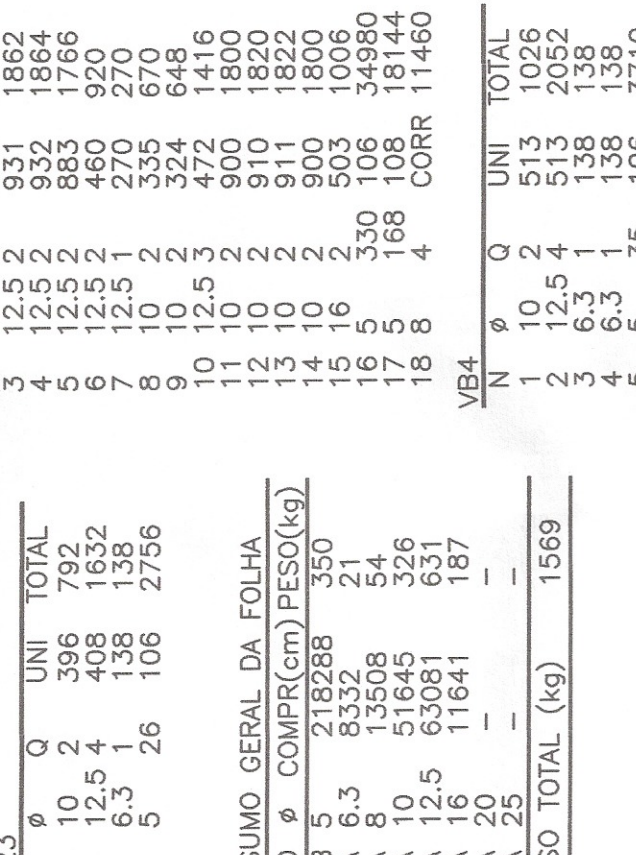

VB3

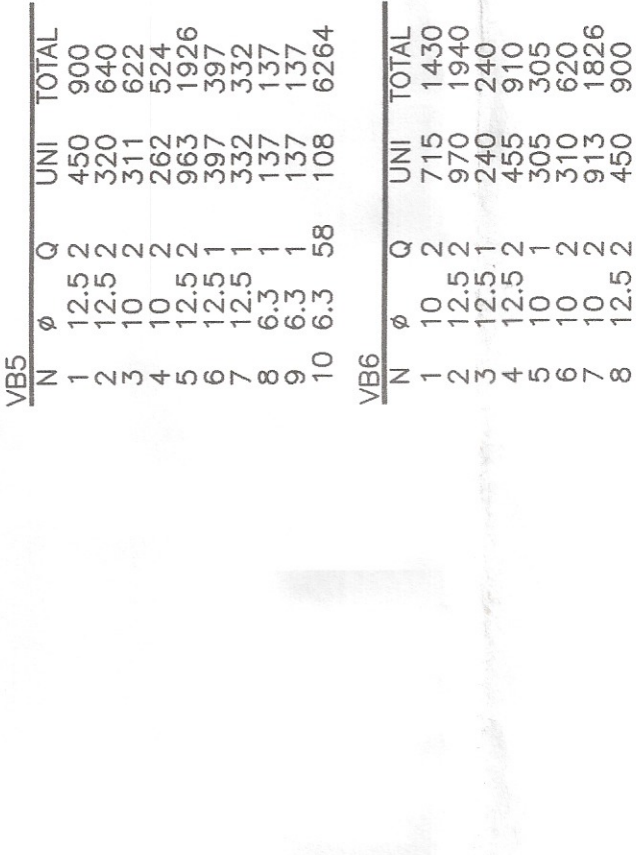

VB5

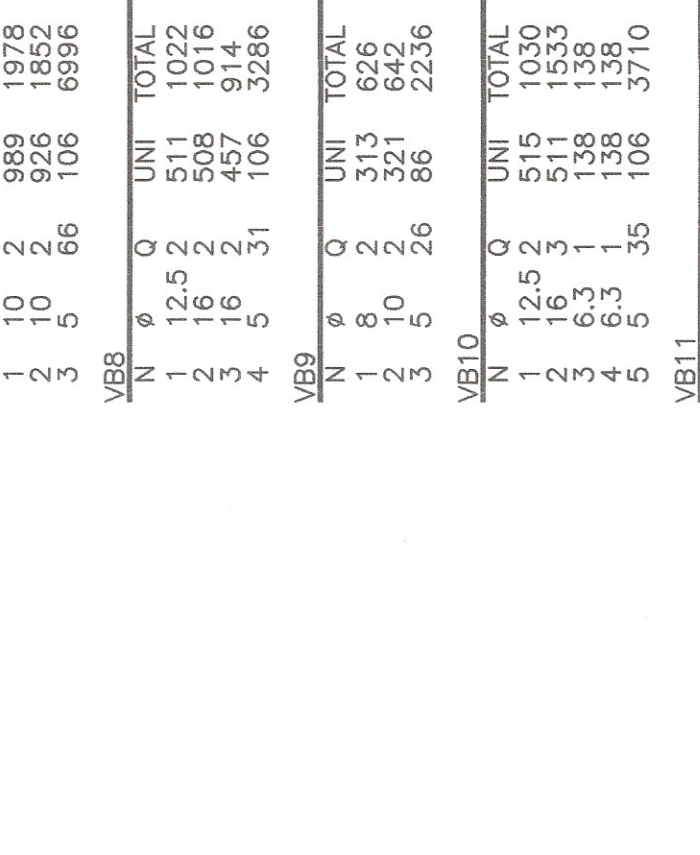

VB11

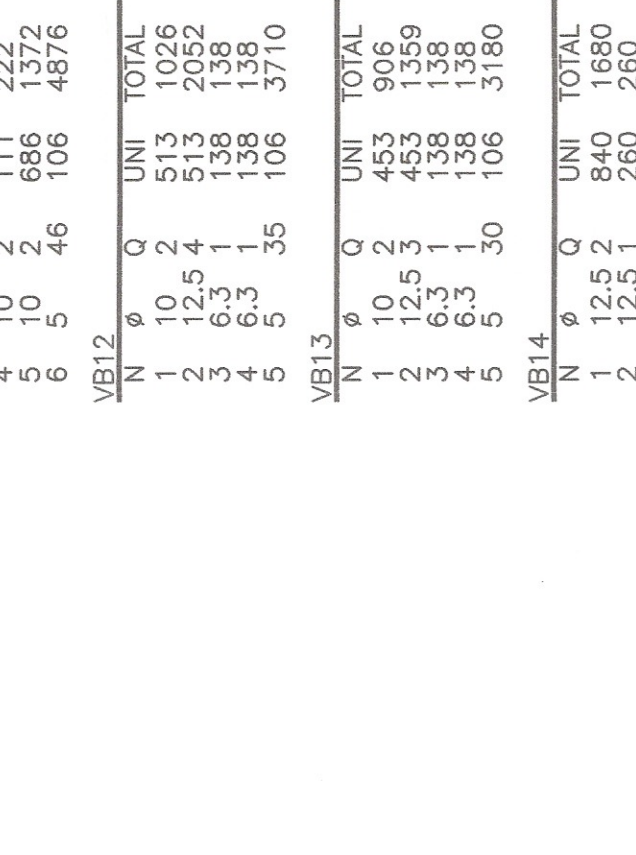

VB14

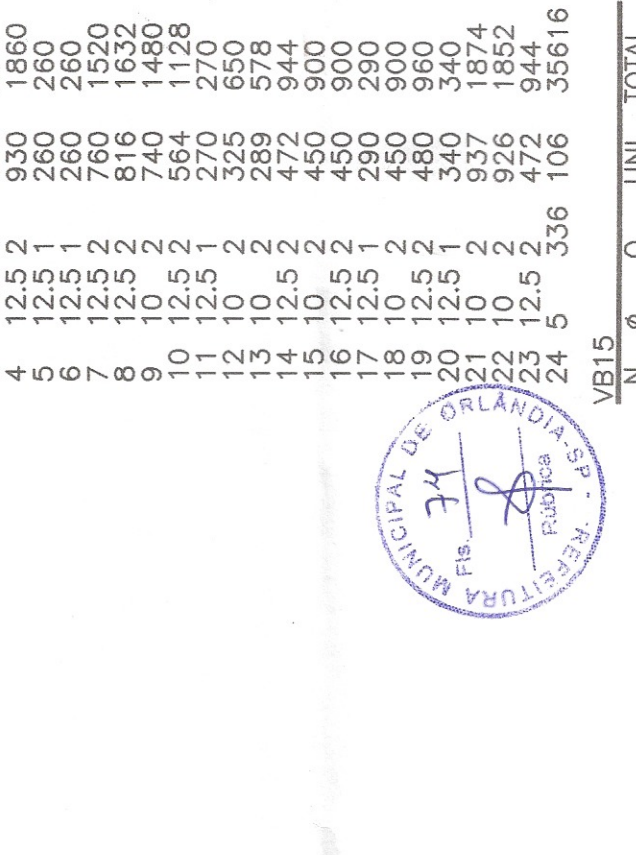

VB15

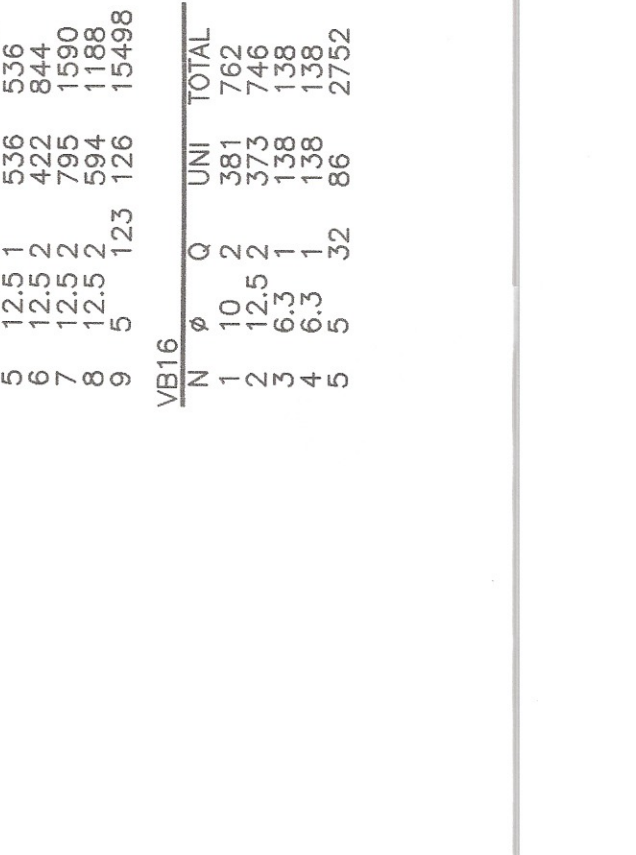

aplaçacs arquitetos

RESUMO DO PROJETO

PROJETO EXECUTIVO DE ESTRUTURA

ARMADURA DAS VIGAS DA FUNDAÇÃO (01/02)

12/02/2019

PC - 01

05/08

00

FUNDAÇÃO PARA O DESENVOLVIMENTO DA EDUCAÇÃO - F D E

TERRENO CBH JOSÉ VIEIRA BRAZÃO - ORLANDO - SP

OBRA NOVA DE CRECHE

PROJETO EXECUTIVO DE ESTRUTURA

ARMADURA DAS VIGAS DA FUNDAÇÃO (01/02)

RESUMO DO PROJETO

PROJETO EXECUTIVO DE ESTRUTURA

ARMADURA DAS VIGAS DA FUNDAÇÃO (01/02)

RESUMO DO PROJETO

PROJETO EXECUTIVO DE ESTRUTURA

ARMADURA DAS VIGAS DA FUNDAÇÃO (01/02)

DETALHE DO PISO DE CIMENTAÇÃO (01)

RESUMO DO PROJETO

PROJETO EXECUTIVO DE ESTRUTURA

ARMADURA DAS VIGAS DA FUNDAÇÃO (01/02)

NOTAS

01-CONCRETO F25 25 MPa

02-ARMAÇÃO Ø10 - fy=500 MPa

03-MEDIDAS EM CM. INTES EM M.

04-NÃO TRAR MEDIDAS EM LOCAL.

05-ORIENTAÇÃO DO LOCAL.

DESIGNO DE REFERÊNCIA

DESENVOLVIMENTO DA EDUCAÇÃO

ARMADURA DAS VIGAS DA FUNDAÇÃO (01/02)

MODIFICAÇÕES

DESENVOLVIMENTO DA EDUCAÇÃO

ARMADURA DAS VIGAS DA FUNDAÇÃO (01/02)

DESENVOLVIMENTO DA EDUCAÇÃO

ARMADURA DAS VIGAS DA FUNDAÇÃO (01/02)

DESENVOLVIMENTO DA EDUCAÇÃO